

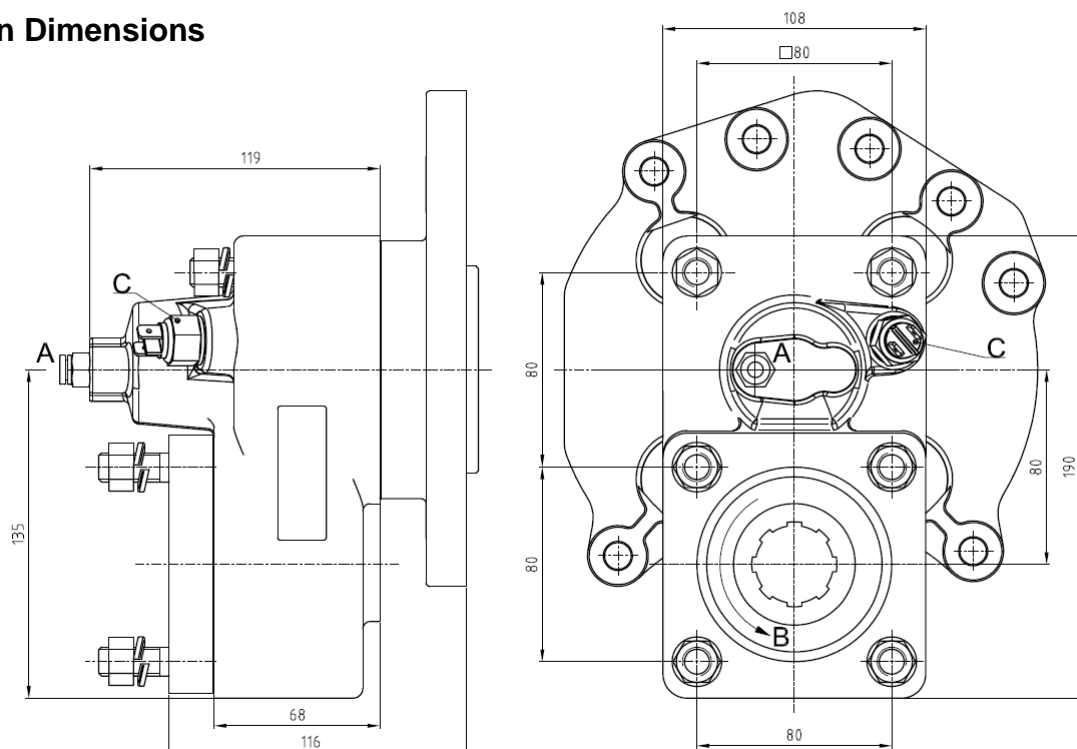

Power Take Offs		Ref. TF8007AMP
MERCEDES	G4/65 ; G4/95 ; G4/110	

To apply with Gear Pumps or with Piston Pumps

Main Dimensions



A – Air connection

B – Pump rotation

C – Option: Electric sensor with mechanical driving Ref. TF8007AMPS or TF8007AMPC

(Dimensions in mm)

Main Data

Continuous Torque (Nm)		300
Intermittent Torque (Nm)		420
Power (at 1000 rpm)		42 cv / 32 kW
Mounting Position		Rear
Pump Rotation		Right Hand
Weight (kg)		11
PTO internal ratio		1:1,32
Indicative ratio from motor to PTO's output		
G4/65 - 6/ 9	- 1 : 0.620	GV4/65 - 6/ 9 High: -1 : 0.742 Normal - 1 : 0.620
G4/65 - 7/ 11	- 1 : 0.541	GV4/95 - 6/ 9 High: -1 : 0.742 Normal - 1 : 0.620
GV4/95 - 6/ 9	- 1 : 0.620	GV4/110 - 6/ 9 High: -1 : 0.742 Normal - 1 : 0.620
GV4/95 - 7/ 11	- 1 : 0.541	
G4/110 - 6/ 9	- 1 : 0.620	

CTI TF8007AMP 1211- 0

ABER is constantly engaged in improving its products and, therefore, reserves itself the right to modify without any further notice the characteristics shown. The gear boxes are in constant change; therefore, ABER is not to be held responsible for any damage resulting from wrong application or application of outdated material.



ABER - Embraiaçes e Comandos Hidráulicos - A. B. LDA

Rua Francisco de Almeida, Nº 30 – Vila Nova da Telha – 4470 MAIA - Portugal

Telephone: +351.22.9438070 Fax: +351.22.9420823 e-mail: aber@aber.pt <http://www.aber.pt>

1/1