



Power Take Offs

Relation 1 : 1,56

Ref. TF5010AMP

VOLVO

R1000; SR1000; R1400; R1700; SR1400; SR1700; SR1900;
SR2000; SR2400; SRO2400; VT1708; VT2009B; VT2014B; VT2214;
VT2412B; VT2514B; VTO2214B; VTO2514B; VT2814B; VTO2814B

To apply with Gear Pumps or with Piston Pumps

Main Dimensions

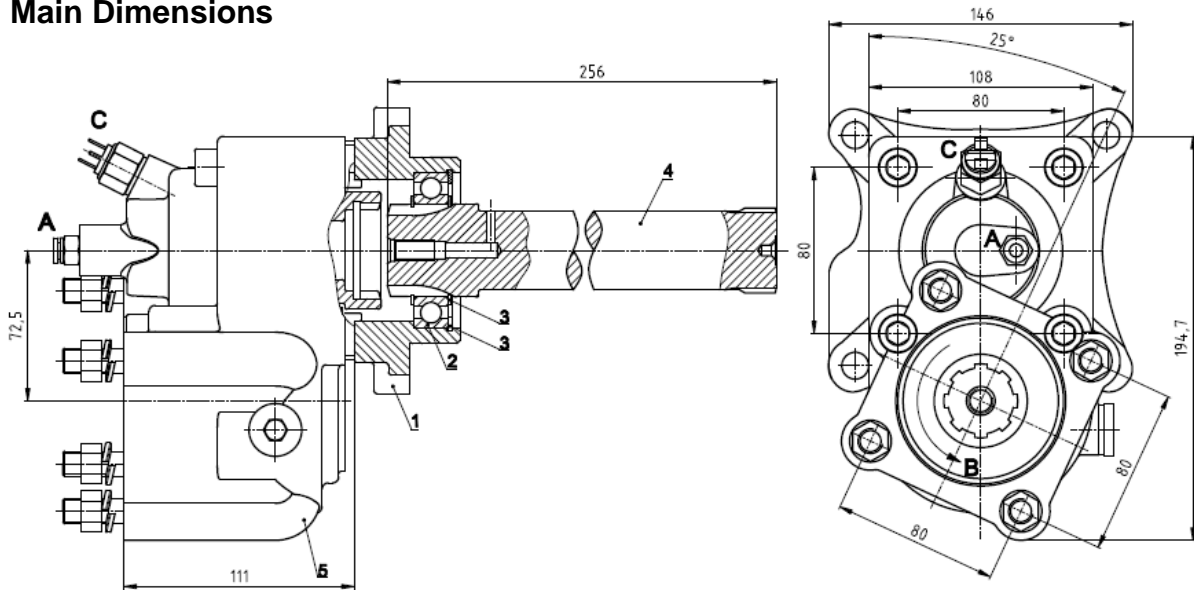

- A – Air connection
- B – Sense of rotation
- C – Option: Electric sensor with mechanical driving Ref. TF5010AMPS or TF5010AMPC
- 1 – Flange
- 2 – Bearing
- 3 – Circlip
- 4 – Adapter shaft VK5004
- 5 – TF4035AMP

(Dimensions in mm)

Main Data

Continuous Torque (Nm)	400	
Intermittent Torque (Nm)	500	
Power (at 1000 rpm)	55 cv / 40 kW	
Mounting Position	Rear	
Pump Rotation	Right Hand	
Weight (kg)	16	
PTO internal ratio	1:1,56	
Indicative ratio from motor to PTO's output		
R 1000 ; R 1400 ; R 1700 ; VT1708 ; VT2009B	.- 1 : 1.092	
SR 1400 ; SR 1700 ; SR 1900 ; VT2014B ; VT2214 ; VT2514B	High: .- 1 : 1.373	Normal: .- 1 : 1.092
SR 2000	High: .- 1 : 1.279	Normal: .- 1 : 2.574
SRO 2400	High: .- 1 : 1.607	Normal: .- 1 : 1.279
VT2412B	High: .- 1 : 1.409	Normal: .- 1 : 1.092
VTO2214B ; VTO2514B	High: .- 1 : 1.707	Normal: .- 1 : 1.373

CTI TF5010AMP 1211-1

ABER is constantly engaged in improving its products and, therefore, reserves itself the right to modify without any further notice the characteristics shown. The gear boxes are in constant change; therefore, ABER is not to be held responsible for any damage resulting from wrong application or application of outdated material.



ABER - Embraagens e Comandos Hidráulicos - A. B. LDA

Rua Francisco de Almeida, Nº 30 – Vila Nova da Telha – 4470 MAIA - Portugal

Telephone: +351.22.9438070 Fax: +351.22.9420823 e-mail: aber@aber.pt <http://www.aber.pt>

1/1