



## Power Take Offs

Relation 1 : 1,32

Ref. TF5001AMP

**VOLVO**

R50 ; R51 ; R52 ; SR52

To apply with Gear pumps or with Piston Pumps

### Main Dimensions

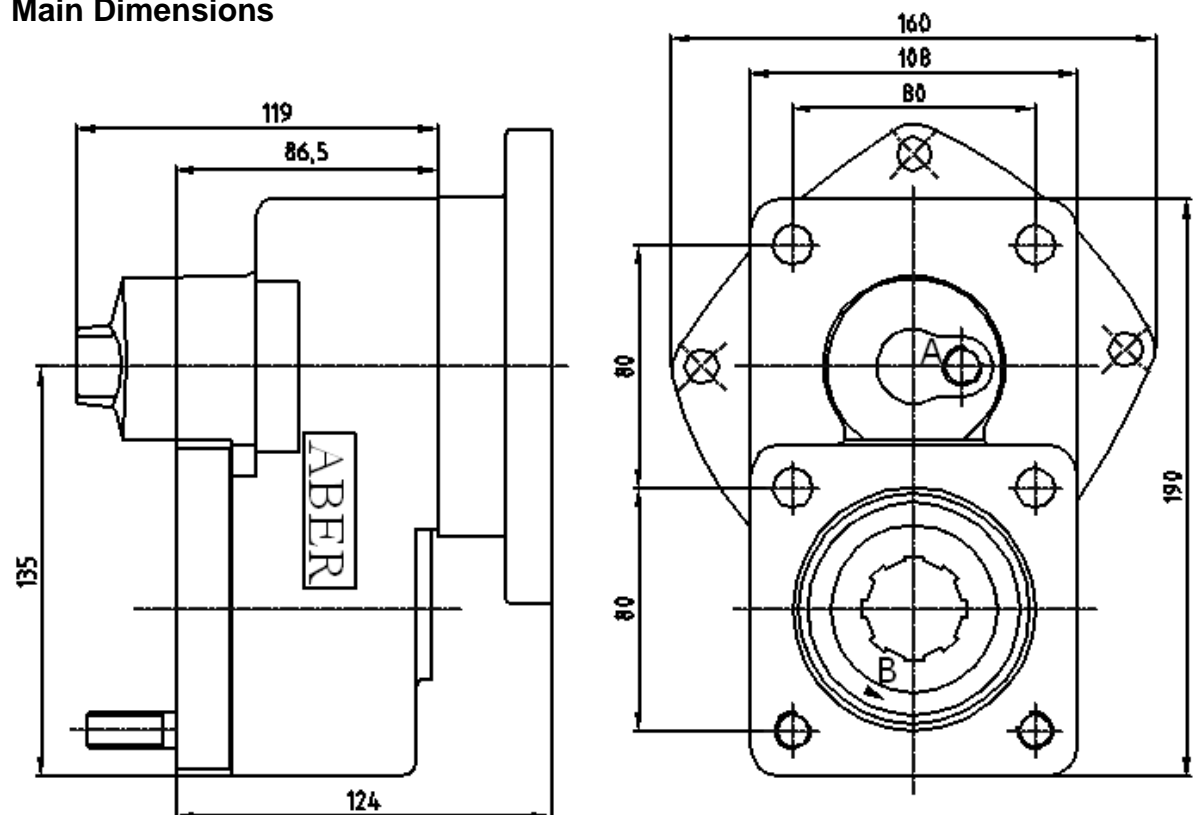

A – Air connection

B – Pump rotation

Option: Electric sensor with mechanical driving Ref. TF5001AMPS or TF5001AMPC

(Dimensions in mm)

### Main Data

Continuous Torque (Nm)	300
Intermittent Torque (Nm)	420
Power (at 1000 rpm)	42 cv / 32 kW
Mounting Position	Rear
Pump Rotation	Right Hand
Weight (kg)	9,3
PTO internal ratio	1:1,32
Indicative ratio from motor to PTO's output	
R50 ; R51 ; R52 ; SR 52	1 : 0.760

CTI TF5001AMP 1211-2

ABER is constantly engaged in improving its products and, therefore, reserves itself the right to modify without any further notice the characteristics shown. The gear boxes are in constant change; therefore, ABER is not to be held responsible for any damage resulting from wrong application or application of outdated material.



**ABER - Embraagens e Comandos Hidráulicos - A. B. LDA**

Rua Francisco de Almeida, Nº 30 – Vila Nova da Telha – 4470 MAIA - Portugal

Telephone: +351.22.9438070 Fax: +351.22.9420823 e-mail: [aber@aber.pt](mailto:aber@aber.pt) <http://www.aber.pt>

1/1