



Power Take Offs

Ref. TF1001V

TOYOTA

M150 ; M153 ; M155 Vacuum Control

Main Dimensions

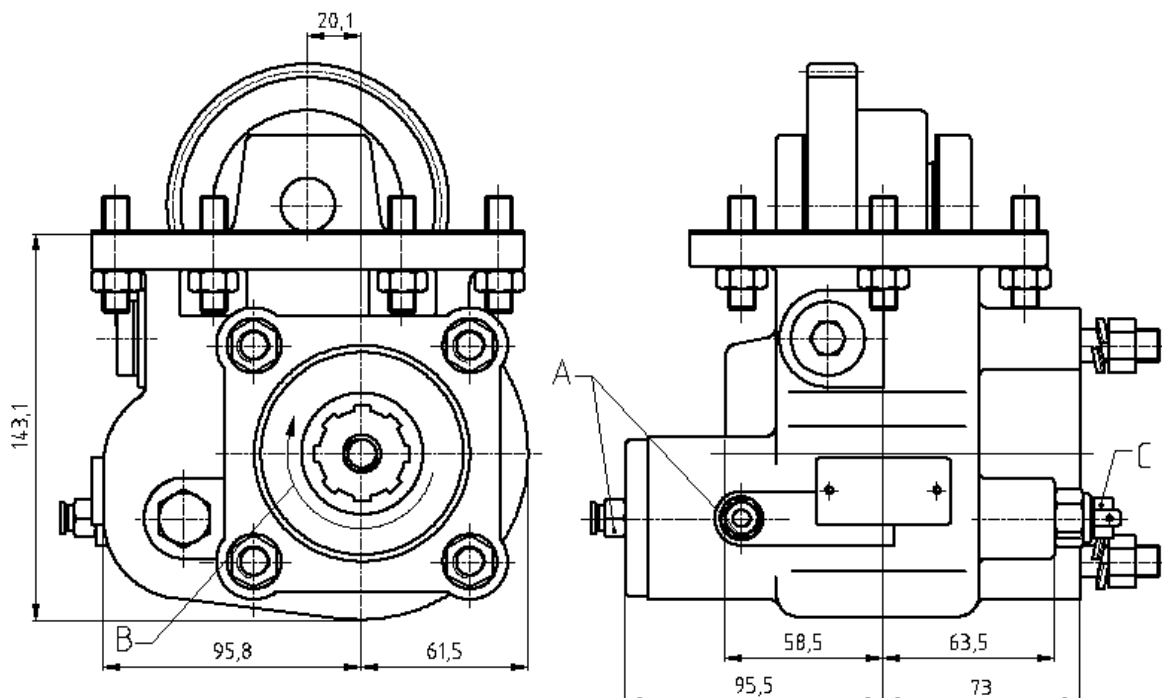

A – Vacuum connection

B – Pump rotation

C – Option: Electric sensor with mechanical driving Ref. TF1001VS or TF1001VC

(Dimensions in mm)

Main Data

Continuous Torque (Nm)	300
Intermittent Torque (Nm)	420
Power (at 1000 rpm)	42 cv / 32 kW
Mounting Position	Left
Pump Rotation	Left Hand
Weight (kg)	13
PTO internal ratio	1:1,13
Indicative ratio from motor to PTO's output	1:0,63

CTI TF1001V 1211-2

ABER is constantly engaged in improving its products and, therefore, reserves itself the right to modify without any further notice the characteristics shown. The gear boxes are in constant change; therefore, ABER is not to be held responsible for any damage resulting from wrong application or application of outdated material.



ABER - Embraiaçes e Comandos Hidráulicos - A. B. LDA

Rua Francisco de Almeida, Nº 30 – Vila Nova da Telha – 4470 MAIA - Portugal

Telephone: +351.22.9438070 Fax: +351.22.9420823 e-mail: aber@aber.pt <http://www.aber.pt>

1/1